



1 bed apartment to buy in NE37

Waterloo Walk, Washington, Washington,
Tyne and Wear, NE37 3EN

£15,000 Starting Bid

🛏 x1 🚿 x1 🚻 x1

Tenure

Leasehold

Allocated parking

Property features

✓ EPC Rating C

Key Information

- ✓ Council Tax: Band A
- ✓ EPC Rating: C
- ✓ Heating supply: Gas

Description

TO BE SOLD VIA ONLINE AUCTION - FEES APPLY.

One bedroom upper flat in a popular residential area close to local industry, schools and amenities.

We welcome to the rental market this generously proportioned one bedroom property in a quiet location. The property in brief comprises; entrance hallway leading to lounge, kitchen, bathroom and double bedroom. The property also benefits from a balcony which can be accessed through the lounge new carpets and re-decorated throughout

Communal lawn gardens, elevator access and ample communal parking to the side aspect.

Please call the Washington branch to arrange a viewing on 01914154467

Council Tax Band: A

Tenure: Leasehold

Price: Starting Bid £15,000

Property Type: Apartment

Parking: Allocated

Heating: Gas

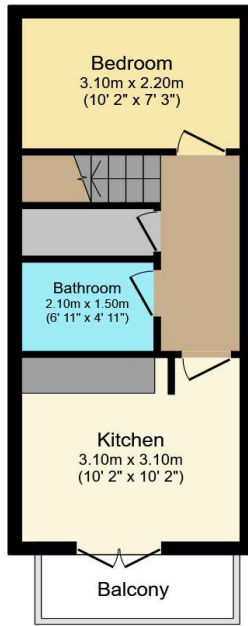

Floor Plan

Floor area 30.5 sq.m. (328 sq.ft.)

TOTAL: 30.5 sq.m. (328 sq.ft.)

This floor plan is for illustrative purposes only. It is not drawn to scale. Any measurements, floor areas (including any total floor area), openings and orientations are approximate. No details are guaranteed, they cannot be relied upon for any purpose and do not form any part of any agreement. No liability is taken for any error, omission or misstatement. A party must rely upon its own inspection(s). Powered by www.Propertybox.io

| Energy Efficiency Rating | | Current | Potential |
|--|--|-------------------------|-----------|
| <i>Very energy efficient - lower running costs</i> | | | |
| (92-100) A | | | |
| (81-91) B | | | |
| (69-80) C | | 77 | 77 |
| (55-68) D | | | |
| (39-54) E | | | |
| (21-38) F | | | |
| (1-20) G | | | |
| <i>Not energy efficient - higher running costs</i> | | | |
| England, Scotland & Wales | | EU Directive 2002/91/EC | |

Waterloo Walk, Washington, Washington, Tyne and Wear, NE37 3EN

Contact your local branch today for more information on this property:

19 West St. Marys Gate, Grimsby, Lincolnshire, DN31 1LE, Tel: 01472 311 113, enquiries@jacksongreenpreston.co.uk, https://www.jacksongreenpreston.co.uk/

These particulars, whilst believed to be accurate are set out as a general outline only for guidance and do not constitute any part of an offer or contract. Intending purchasers should not rely on them as statements of representation of fact, but must satisfy themselves by inspection or otherwise as to their accuracy. No person in this firms employment has the authority to make or give any representation or warranty in respect of the property.

