

## 4 bed town house to buy in LS27

Prospect Mews, Morley, Morley, West  
Yorkshire, LS27 9EQ

**£200,000** Starting Bid

 x4  x2  x1

Tenure

**Freehold**

Allocated parking

## Property features

- ✓ Being Sold via Secure Sale Online Bidding. Terms & Conditions
- ✓ No Vendor Chain
- ✓ 4 Bedroom Townhouse
- ✓ Catchment Area for Well Regarded Schools
- ✓ EPC Rating C

## Key Information

- ✓ Council Tax: Band C
- ✓ EPC Rating: C
- ✓ Heating supply: Gas
- ✓ Electric supply: National Grid
- ✓ Water supply: Direct mains water
- ✓ Broadband: FTTC (fibre to the cabinet)
- ✓ Mobile signal: Good

## Description

Nestled at the head of a popular cul-de-sac upon the cusp on Morley Town Centre and Churwell Hill is this superb four bedroom Town House.

Providing living accommodation across three floors, including principal en-suite to the master, integral garage, off road parking and enclosed rear garden, this home is perfect for growing families wanting a sizeable home within a superb location, and investors alike.

Council Tax Band: C

Tenure: Freehold

Price: Starting Bid £200,000

Property Type: Town House

Parking: Allocated

Construction materials: Brick and block

Roofing type: Slate tiles

Heating: Gas

Electric: National Grid

Water: Direct mains water

Sewerage: Standard UK domestic

Air conditioning: No

Broadband: FTTC (fibre to the cabinet), FTTP (fibre to the premises)

Mobile signal coverage: Good

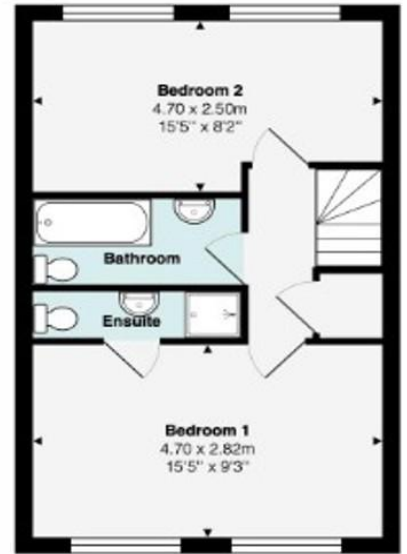
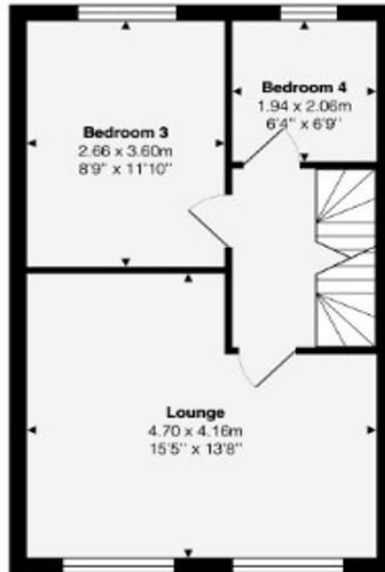
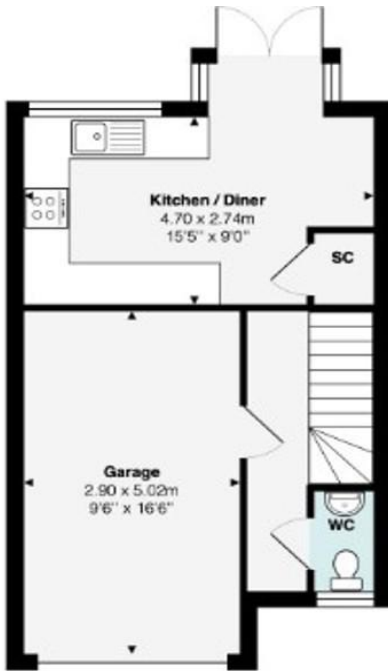

**Prospect Mews, Morley, LS27 9EQ**

Total Area: 109.0 m<sup>2</sup> ... 1173 ft<sup>2</sup>

Whilst every attempt has been made to ensure the accuracy of the floor plan, measurements of doors, windows and rooms and any other items are approximate and no responsibility is taken for any error, omissions or mis-statement. The plan is for illustrative purposes only and should be used as such.



Energy Efficiency Rating		Current	Potential
<i>Very energy efficient - lower running costs</i>			
(92-100) <b>A</b>			
(81-91) <b>B</b>			87
(69-80) <b>C</b>		74	
(55-68) <b>D</b>			
(39-54) <b>E</b>			
(21-38) <b>F</b>			
(1-20) <b>G</b>			
<i>Not energy efficient - higher running costs</i>			
<b>England, Scotland &amp; Wales</b>		EU Directive 2002/91/EC	

Prospect Mews, Morley, Morley, West Yorkshire, LS27 9EQ

Contact your local branch today for more information on this property:

**19 West St. Marys Gate, Grimsby, Lincolnshire, DN31 1LE, Tel: 01472 311 113, enquiries@jacksongreenpreston.co.uk, https://www.jacksongreenpreston.co.uk/**

These particulars, whilst believed to be accurate are set out as a general outline only for guidance and do not constitute any part of an offer or contract. Intending purchasers should not rely on them as statements of representation of fact, but must satisfy themselves by inspection or otherwise as to their accuracy. No person in this firm's employment has the authority to make or give any representation or warranty in respect of the property.

