



2 bed bungalow to buy in NE23

Boulmer Avenue, Cramlington,
Cramlington, Northumberland, NE23 3QY

£199,500 Offers Over

 x2  x1  x1

Tenure

Freehold

Property features

- ✓ Bungalow in a great location!
- ✓ Refurbished kitchen
- ✓ Low maintenance garden
- ✓ Driveway
- ✓ EPC Rating C

Driveway parking

Garden

Key Information

- ✓ Council Tax: Band B
- ✓ EPC Rating: C
- ✓ Heating supply: Gas

Description

Super opportunity to purchase a bungalow in the sought after Northburn estate within Cramlington. A popular established area with a great range of amenities, shops and travel links.

This home has some great features, including a refurbished kitchen and a lovely low maintenance garden.

The accommodation includes entrance hallway, living/dining room, kitchen, bathroom and two bedrooms. Externally there is a good sized driveway and a low maintenance garden offering a good deal of privacy.

The current owner has upgraded the kitchen to provide a modern and practical space. This home is in a prime location and is ready to move into.

Contact us now to arrange your viewing.

Council Tax Band: B

Tenure: Freehold

Price: Offers Over £199,500

Property Type: Bungalow

USPs: Garden

Parking: Driveway

Heating: Gas

Entrance hallway



Living/dining Room



Kitchen



Conservatory



Internal hallway



Bedroom 1



Bedroom 2



Bathroom



External



Approx Gross Internal Area
61 sq m / 659 sq ft

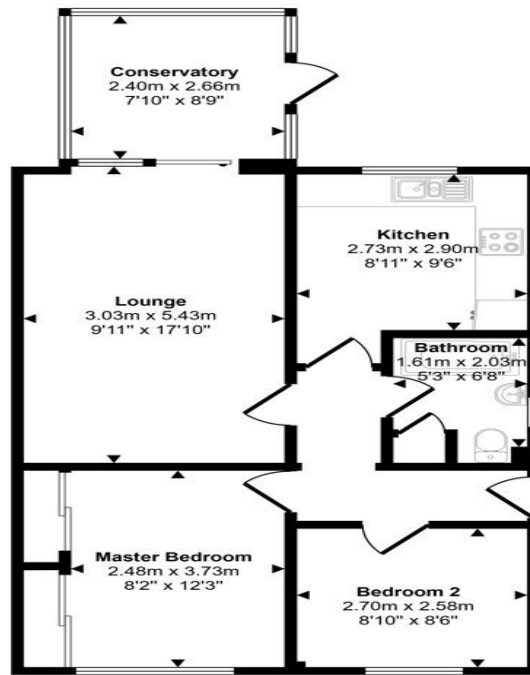

Floorplan

This floorplan is only for illustrative purposes and is not to scale. Measurements of rooms, doors, windows, and any items are approximate and no responsibility is taken for any error, omission or mis-statement. Icons of items such as bathroom suites are representations only and may not look like the real items. Made with Made Snappy 360.

Energy Efficiency Rating		Current	Potential
Very energy efficient - lower running costs			
(92-100) A			
(81-91) B			89
(69-80) C		73	
(55-68) D			
(39-54) E			
(21-38) F			
(1-20) G			
Not energy efficient - higher running costs			
England, Scotland & Wales		EU Directive 2002/91/EC	

Boulmer Avenue, Cramlington, Cramlington, Northumberland, NE23 3QY

Contact your local branch today for more information on this property:

**19 West St. Marys Gate, Grimsby, Lincolnshire, DN31 1LE, Tel: 01472 311 113,
enquiries@jacksongreenpreston.co.uk, https://www.jacksongreenpreston.co.uk/**

These particulars, whilst believed to be accurate are set out as a general outline only for guidance and do not constitute any part of an offer or contract. Intending purchasers should not rely on them as statements of representation of fact, but must satisfy themselves by inspection or otherwise as to their accuracy. No person in this firms employment has the authority to make or give any representation or warranty in respect of the property.

