



1 bed apartment to buy in FY8

Fairhaven Road, Lytham St. Annes,
Lancashire, FY8 1NN

£60,000 Starting Bid

 x1  x1  x1

Tenure

Leasehold

Off Street parking

Property features

- ✓ Being Sold via Secure Sale Online Bidding. Terms & Conditions apply.
- ✓ VERY CLOSE TO THE SEA FRONT
- ✓ VERY LARGE ROOMS
- ✓ GOOD VALUE FOR MONEY
- ✓ EPC Rating C

Key Information

- ✓ Council Tax: Band A
- ✓ EPC Rating: C
- ✓ Heating supply: Gas
- ✓ Electric supply: National Grid
- ✓ Water supply: Direct mains water

Description

Welcome Swiss Court, Fairhaven Road, this 1 bedroom property is a good size, offered with no onward chain and is excellent value for money. The location of the property is highly regarded, Fairhaven Road is situated directly between the Promenade and Clifton Drive South. The flat is a very close to the sea front, local amenities, and is perfectly positioned for transport links. There are a wide range of shops and amenities located on Alexandra Drive

Well Maintained by the Landlord the Property is Neutrally Decorated Throughout and Briefly Comprises Hallway, Good Sized Lounge, Modern Style Kitchen and Bathroom and Spacious Bedroom.

Please note we have been advised the roof to the building will need to be replaced and the cost would likely fall onto the leaseholders. We have not been made aware of how much this cost will be.

Council Tax Band: A

Tenure: Leasehold

Length of Lease: 102

Annual Ground Rent Amount: £200.00

Annual Service Charge Amount: £1,244.00

Price: Starting Bid £60,000

Property Type: Apartment

Parking: Off Street

Construction materials: Brick and block

Risk of floods and or erosion: No

Flooded in last 5 years: No

Flood defences: No

Planning permissions or proposals for development: No

Coalfield or mining area: No

Listed property: No

Conservation area: No

Public rights of way: No

Adaptions for accessibility: No

Restrictions: Yes

Heating: Gas

Electric: National Grid

Water: Direct mains water

Water meter: Yes

Sewerage: Standard UK domestic

Air conditioning: No

Living Room

4.91 x 3.13 m (16'1" x 10'3" ft)

Kitchen

3.58 x 2.27 m (11'9" x 7'5" ft)

Bedroom 1

5.10 x 4.55 m (16'9" x 14'11" ft)

Bathroom

2.10 x 1.98 m (6'11" x 6'6" ft)

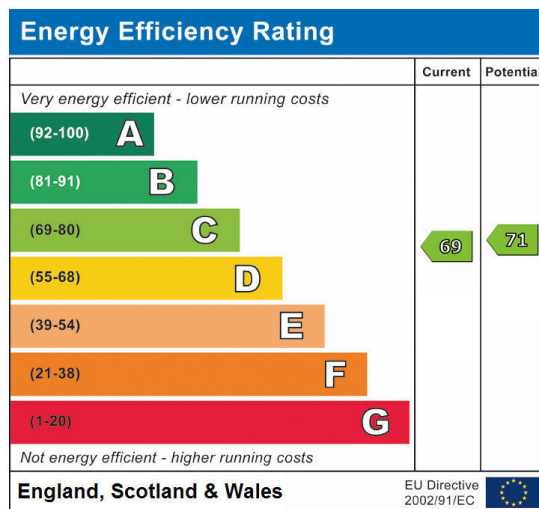
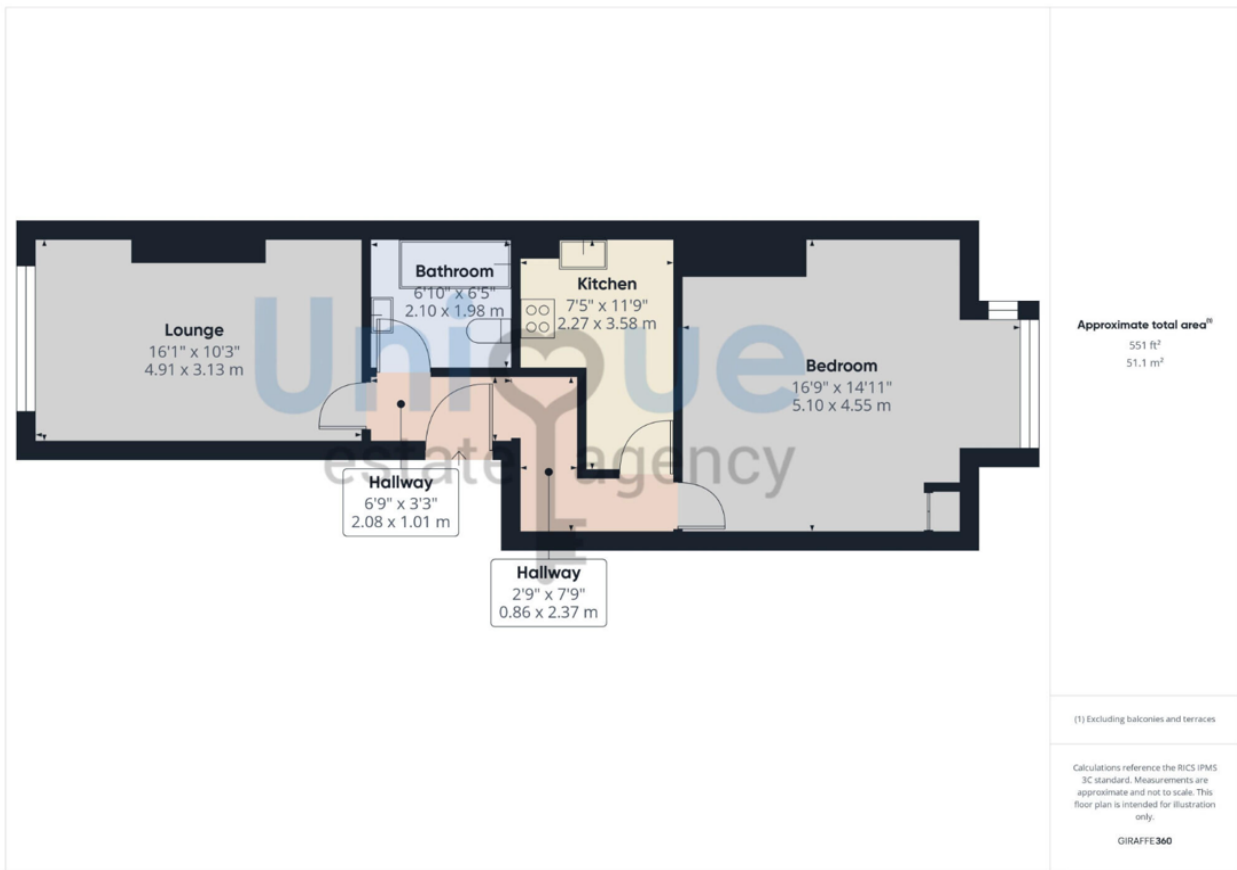

Fairhaven Road, Lytham St. Annes, Lancashire, FY8 1NN

Contact your local branch today for more information on this property:

**19 West St. Marys Gate, Grimsby, Lincolnshire, DN31 1LE, Tel: 01472 311 113,
enquiries@jacksongreenpreston.co.uk, <https://www.jacksongreenpreston.co.uk/>**

These particulars, whilst believed to be accurate are set out as a general outline only for guidance and do not constitute any part of an offer or contract. Intending purchasers should not rely on them as statements of representation of fact, but must satisfy themselves by inspection or otherwise as to their accuracy. No person in this firm's employment has the authority to make or give any representation or warranty in respect of the property.

