

HOMESFORTH



Auction

1 bed flat to buy in NW6

Malvern Road, London, NW6 5PU

£340,000 Starting Bid

 x1  x1  x1

Tenure

Leasehold

On Street parking

Property features

- ✓ Immediate 'exchange of contracts' available
- ✓ Being sold via 'Secure Sale'
- ✓ Close to tube
- ✓ Ground Floor Entrance
- ✓ EPC Rating D

Key Information

- ✓ Council Tax: Band C
- ✓ EPC Rating: D
- ✓ Heating supply: Gas
- ✓ Electric supply: National Grid
- ✓ Water supply: Direct mains water
- ✓ Mobile signal: Good

Description

Charming 1-Bedroom Ground Floor Apartment with Potential in Period Conversion

Nestled in the heart of Malvern Road, NW6, this delightful one-bedroom ground-floor apartment offers a unique opportunity to create your dream home. Situated within a characterful period conversion, the property exudes charm and features high ceilings, large windows, and a spacious layout. While the apartment would benefit from modernisation, it provides a blank canvas to truly make it your own. The existing layout offers versatility, with potential to reconfigure into a two-bedroom home (subject to planning and regulations). Key features include:

Generously sized bedroom and living area

Period features and high ceilings

Private ground-floor access

Ample potential for reconfiguration and updates

Located on a vibrant street with excellent transport links, shops, and local amenities nearby, this property is perfect for first-time buyers, investors, or those seeking a project to maximise value. Don't miss this chance to own a property full of potential in a highly sought-after NW6 location.

Council Tax Band: C

Tenure: Leasehold

Length of Lease: 106

Price: Starting Bid £340,000

Property Type: Flat

Parking: On Street, Permit Parking

Year built: 1900

Construction materials: Brick and block

Known property issues: Damp

Risk of floods and or erosion: No

Flooded in last 5 years: No

Flood defences: No

Planning permissions or proposals for development: No

Coalfield or mining area: No

Listed property: No

Conservation area: No

Public rights of way: No

Adaptions for accessibility: No

Restrictions: No

Required access: No

Heating: Gas

Electric: National Grid

Water: Direct mains water

Water meter: No

Sewerage: Standard UK domestic

Air conditioning: No

Mobile signal coverage: Good

Total Property Floor area approx. 59 m² (plus 18 m² patio).

This Floor Plan should be used as a general outline for guidance only. Any areas, measurements or distances quoted are approximate and should not be used to value a property or be the basis of any sale or let.

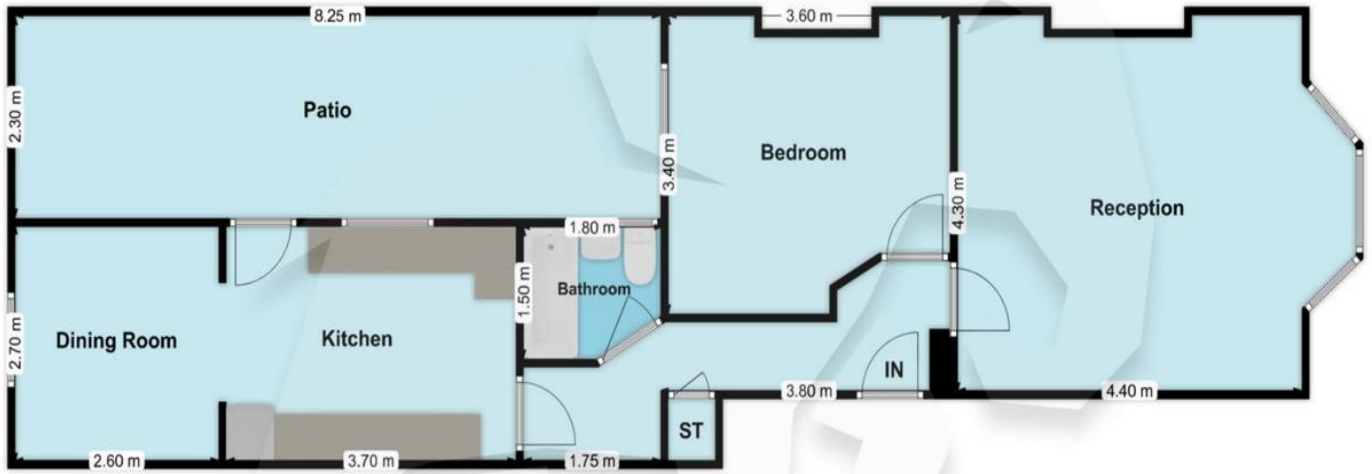

Energy Efficiency Rating		Current	Potential
<i>Very energy efficient - lower running costs</i>			
(92-100) A			
(81-91) B			
(69-80) C			75
(55-68) D	67		
(39-54) E			
(21-38) F			
(1-20) G			
<i>Not energy efficient - higher running costs</i>			
England, Scotland & Wales		EU Directive 2002/91/EC	

Malvern Road, London, NW6 5PU

Contact your local branch today for more information on this property:

19 West St. Marys Gate, Grimsby, Lincolnshire, DN31 1LE, Tel: 01472 311 113, enquiries@jacksongreenpreston.co.uk, https://www.jacksongreenpreston.co.uk/

These particulars, whilst believed to be accurate are set out as a general outline only for guidance and do not constitute any part of an offer or contract. Intending purchasers should not rely on them as statements of representation of fact, but must satisfy themselves by inspection or otherwise as to their accuracy. No person in this firm's employment has the authority to make or give any representation or warranty in respect of the property.

