



3 bed end of terrace house to buy in SR6

Burscough Crescent, Sunderland, Tyne
and Wear, SR6 9SF

£200,000

🏠 x3 🚗 x1 🚗 x1

Tenure

Leasehold

Property features

- ✓ Extended End Terrace House
- ✓ Three Bedrooms
- ✓ Kitchen/Diner
- ✓ UPVC Double Glazing
- ✓ EPC Rating D

Driveway & Garage parking

Key Information

- ✓ Council Tax: Band B
- ✓ EPC Rating: D
- ✓ Heating supply: Gas

Description

This extended end terrace home is ideally situated close to a range of local amenities, including shops, well regarded schools, the seafront, and a nearby Metro station, making it perfect for family living.

The property offers spacious and well-presented accommodation throughout, with features including gas central heating, UPVC double glazing, and a generous kitchen diner ideal for both everyday use and entertaining.

The ground floor comprises an entrance porch, a comfortable lounge with open plan stairs leading to the first floor, and a bright, spacious kitchen diner. To the first floor are three well-proportioned bedrooms and a family bathroom.

Externally, the property benefits from gardens to both the front and rear, and a garage can be located in a nearby block to the rear of the property.

Council Tax Band: B

Tenure: Leasehold

Length of Lease: 947

Price: £200,000

Property Type: End of terrace house

Parking: Driveway & Garage

Heating: Gas

Entrance Porch

UPVC double glazed door and windows

Lounge

4.40m x 4.90m (14'5" x 16'0")

Open plan staircase to the first floor, feature fire surround, radiator, UPVC double glazed window, under stair cupboard, tiled flooring



Kitchen Diner

4.90m x 4.40m (16'0" x 14'5")

Fitted white wall and base units, electric hob and oven, colour coordinated one and a half bowl sink and drainer, combi boiler, floor tiles matching the lounge tiles, UPVC double glazed windows spanning the rear elevation allowing natural light, two sky lights allowing further natural light



First Floor Landing

Loft access with ladder to a boarded loft with skylight



Bedroom 1

2.50m x 4.40m (8'2" x 14'5")

UPVC double glazed window, radiator



Bedroom 2

2.50m x 3.00m (8'2" x 9'10")

UPVC double glazed window, radiator



Bedroom 3

1.80m x 3.20m (5'10" x 10'5")

(Measurements to maximum) UPVC double glazed window, radiator, built in cupboard



Bathroom

1.90m x 1.80m (6'2" x 5'10")

Panelled bath with electric shower and shower screen, WC, wash basin set to a vanity unit, UPVC double glazed window, radiator, tiled walls



External

Gravel garden to the front and a garden to the rear



Approx Gross Internal Area
75 sq m / 803 sq ft

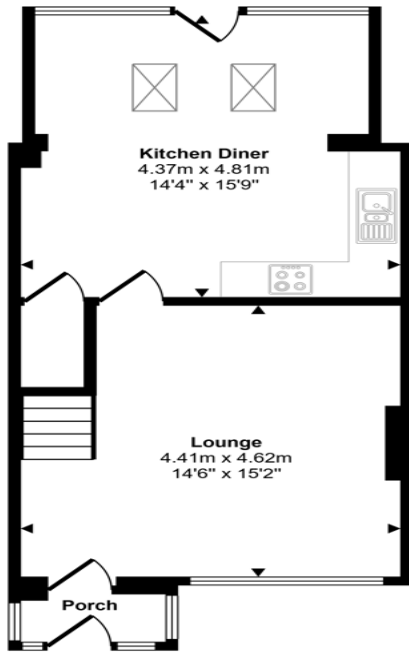

Ground Floor
Approx 43 sq m / 459 sq ft

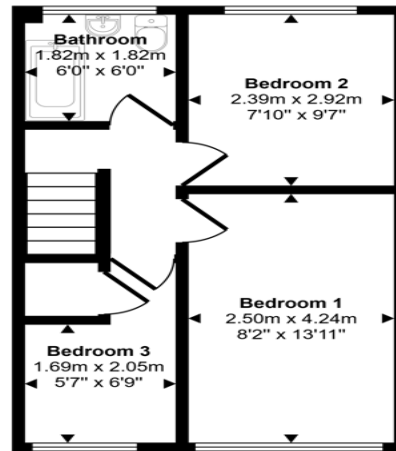

First Floor
Approx 32 sq m / 343 sq ft

This floorplan is only for illustrative purposes and is not to scale. Measurements of rooms, doors, windows, and any items are approximate and no responsibility is taken for any error, omission or mis-statement. Icons of items such as bathroom suites are representations only and may not look like the real items. Made with Made Snappy 360.

Energy Efficiency Rating		Current	Potential
<i>Very energy efficient - lower running costs</i>			
(92-100) A			
(81-91) B			
(69-80) C			79
(55-68) D		63	
(39-54) E			
(21-38) F			
(1-20) G			
<i>Not energy efficient - higher running costs</i>			
England, Scotland & Wales		EU Directive 2002/91/EC	

Burscough Crescent, Sunderland, Tyne and Wear, SR6 9SF

Contact your local branch today for more information on this property:

**19 West St. Marys Gate, Grimsby, Lincolnshire, DN31 1LE, Tel: 01472 311 113,
enquiries@jacksongreenpreston.co.uk, <https://www.jacksongreenpreston.co.uk/>**

These particulars, whilst believed to be accurate are set out as a general outline only for guidance and do not constitute any part of an offer or contract. Intending purchasers should not rely on them as statements of representation of fact, but must satisfy themselves by inspection or otherwise as to their accuracy. No person in this firm's employment has the authority to make or give any representation or warranty in respect of the property.



<https://www.jacksongreenpreston.co.uk/> - 01472 311 113