



3 bed town house to buy in NE23

Saxilby Close, St. Nicholas Manor,
Cramlington, Northumberland, NE23 1AZ

£189,950 Offers over

 x3  x1  x1

Tenure

Freehold

Driveway parking

Property features

- ✓ Three Bedrooms
- ✓ Driveway
- ✓ Garden
- ✓ Close to Town Centre
- ✓ EPC Rating B

Key Information

- ✓ Council Tax: Band B
- ✓ EPC Rating: B
- ✓ Heating supply: Gas

Description

Nestled in the sought after St Nicolas Manor within easy walking distance to local shops and amenities, this impressive three-bedroom mid-terrace home presents a wonderful opportunity for families and professionals alike. The property boasts three generously sized double bedrooms, ensuring ample space and comfort for all residents.

Tastefully presented throughout and maintained in good condition, the home features a modern kitchen diner, perfect for entertaining or enjoying family meals together. The light filled kitchen/diner opens with french doors to the westerly facing garden, offering a spot to relax or host summer gatherings as the sun sets.

Outside, there is convenient off street parking on the private driveway, alleviating any worries about parking. Cramlington train station is within walking distance, the property enjoys a prime position close to a variety of local transport links, well-regarded schools, cafes, and parks, making day-to-day living a pleasure.

Don't miss the chance to make this modern and inviting home yours—arrange a viewing today to experience everything it has to offer.

Council Tax Band: B

Tenure: Freehold

Price: Offers over £189,950

Property Type: Town House

Parking: Driveway

Heating: Gas

Entrance hallway

Living Room



Kitchen/diner



Cloaks w/c



Landing

Bedroom 1



Bedroom 2



Bedroom 3



Bathroom



Garden



Approx Gross Internal Area
88 sq m / 947 sq ft

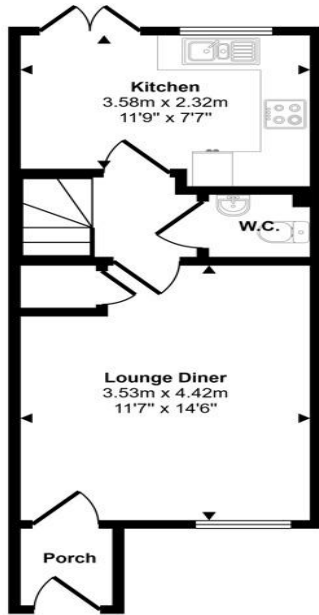

Ground Floor
Approx 32 sq m / 340 sq ft

Denotes head height below 1.5m

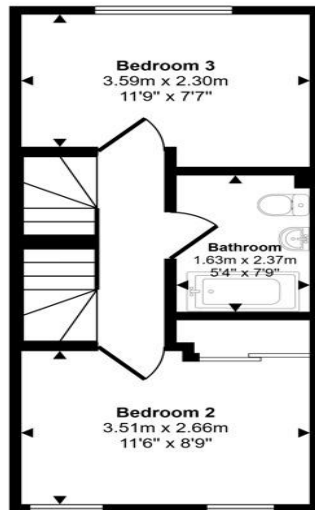

First Floor
Approx 30 sq m / 325 sq ft

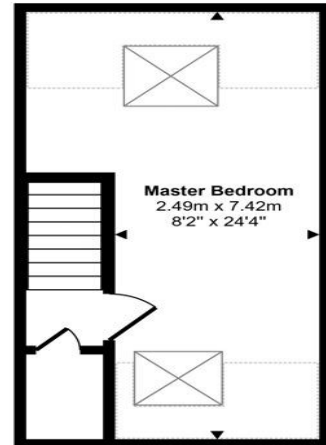

Second Floor
Approx 26 sq m / 282 sq ft

This floorplan is only for illustrative purposes and is not to scale. Measurements of rooms, doors, windows, and any items are approximate and no responsibility is taken for any error, omission or mis-statement. Icons of items such as bathroom suites are representations only and may not look like the real items. Made with Made Snappy 360.

Energy Efficiency Rating		
	Current	Potential
<i>Very energy efficient - lower running costs</i>		
(92-100) A		95
(81-91) B	84	
(69-80) C		
(55-68) D		
(39-54) E		
(21-38) F		
(1-20) G		
<i>Not energy efficient - higher running costs</i>		
England, Scotland & Wales	EU Directive 2002/91/EC	

Saxilby Close, St. Nicholas Manor, Cramlington, Northumberland, NE23 1AZ

Contact your local branch today for more information on this property:

**19 West St. Marys Gate, Grimsby, Lincolnshire, DN31 1LE, Tel: 01472 311 113,
enquiries@jacksongreenpreston.co.uk, <https://www.jacksongreenpreston.co.uk/>**

These particulars, whilst believed to be accurate are set out as a general outline only for guidance and do not constitute any part of an offer or contract. Intending purchasers should not rely on them as statements of representation of fact, but must satisfy themselves by inspection or otherwise as to their accuracy. No person in this firm's employment has the authority to make or give any representation or warranty in respect of the property.

